



SOLUTION GUIDE

1.2.0 | April 2021 |

Poly Solutions for Microsoft Teams Rooms for Poly G10-T, Poly G40-T, and Poly G85-T

Getting Help

For more information about installing, configuring, and administering Poly/Polycom products or services, go to Polycom Support.

Plantronics, Inc. (Poly — formerly Plantronics and Polycom)
345 Encinal Street
Santa Cruz, California
95060

© 2021 Plantronics, Inc. All rights reserved. Poly, the propeller design, and the Poly logo are trademarks of Plantronics, Inc. All other trademarks are the property of their respective owners.

Contents

Poly Solutions for Microsoft Teams Rooms.....	3
What's New in This Release.....	4
Release History.....	4
Products Tested with This Release.....	4
 Getting Started.....	 6
Poly G10-T for Microsoft Teams Rooms.....	6
Poly G40-T for Microsoft Teams Rooms.....	8
Poly G85-T for Microsoft Teams Rooms.....	9
Required Microsoft Licenses and Accounts.....	11
Required License for Microsoft Teams Rooms	11
Microsoft Teams Rooms Account.....	11
 Cable the Poly Solution for Microsoft Teams Rooms.....	 12
Connect the Poly GC8 to the Lenovo device.....	12
Connect a USB Camera to the System.....	15
Connect the Poly Studio USB Video Bar to the Lenovo device.....	15
Connect an EagleEye Director II to a Microsoft Teams Rooms System.....	15
Connect a Poly Trio to the Microsoft Teams Rooms Solution.....	16
Connect a Poly Supported Mono DSP to the EagleEye Director II.....	17
Connect a Poly Supported Stereo DSP to the EagleEye Director II.....	18
Connect One or Two Monitors to the System.....	19
Connect the Computer to the Network.....	20
 Power On and Set Up Your Microsoft Teams Rooms Solution.....	 21
Power on the Components and Complete Windows Setup.....	21
Complete the Microsoft Teams Rooms Out-of-Box Setup	22
Access Additional Settings.....	23
Enable Dual Monitor Mode.....	23
Update the Computer.....	23
 System Maintenance.....	 25
Automatic Microsoft Teams Rooms System Updates.....	25
Manually Updating the Microsoft Teams Room Application.....	25
Access Windows on the Lenovo Device.....	25
Factory Restore the Poly GC8.....	26

Factory Reset the Poly GC8..... 26

Poly Solutions for Microsoft Teams Rooms Cabling Diagrams.....27

 Poly G10-T Cabling Diagram..... 27

 Poly G40-T Cabling Diagram..... 28

 Poly G85-T Cabling Diagram..... 28

Related Poly and Partner Resources..... 0

 Privacy Policy..... 0

Poly Solutions for Microsoft Teams Rooms

Topics:

- [What's New in This Release](#)
- [Release History](#)
- [Products Tested with This Release](#)

The Poly Solutions for Microsoft Teams Room Release Notes includes the Poly G10-T, Poly G40-T, and Poly G85-T.

Tip: To save a PDF of this guide, select the PDF icon on the upper right-side of this page and select **Save all topics**.

- **Poly G10-T**



- **Poly G40-T**



- **Poly G85-T**



What's New in This Release

The 1.2.0 release of the G10-T, G40-T, and G85-T firmware includes the following enhancement to the Poly GC8 touch controller:

When using the Poly GC8 as a Windows touch device, you can press and hold the Poly GC8 screen to perform right-click behaviors.

Release History

This section lists the release history of Poly G10-T, Poly G40-T, and Poly G85-T.

Release History

Release	Release Date	Features
1.2.0	March 2021	Press and hold feature on the Poly GC8 to perform right-click behaviors. Bug fixes
1.1.1	November 2020	Updated Poly GC8 LCD driver Improved Poly GC8 motion sensor stability
1.0	October 2020	G85-T initial release
1.0	September 2020	G10-T and G40-T initial release

Products Tested with This Release

Poly products are tested extensively with a wide range of products. The following table lists the products that have been tested for compatibility with this release.

Poly strives to support any system that is standards-compliant, and Poly investigates reports of Poly systems that don't interoperate with other standards-compliant vendor systems.

Note that the following list isn't a complete inventory of compatible equipment, but the products that have been tested with this release.

Products Tested with This Release

Product	Tested Versions
Poly GC8	1.2.0.0242
Polycom EagleEye Director II	2.2.0.43
Poly Studio USB video bar	1.3.0 and 1.4.000781

Supported Digital Signal Processors (DSPs)

Product	Link
Shure P300	https://www.shure.com/en-US/conferencing-meetings/solutions/ecosystem
QSC Q-Sys	https://www.qsc.com/systems/strategic-alliances/microsoft-teams/
Biamp Tesira Forte	https://www.biamp.com/solutions/applications/microsoft-teams-rooms

Getting Started

Topics:

- [Poly G10-T for Microsoft Teams Rooms](#)
- [Poly G40-T for Microsoft Teams Rooms](#)
- [Poly G85-T for Microsoft Teams Rooms](#)
- [Required Microsoft Licenses and Accounts](#)

Before installing a Poly Solution for Microsoft Teams Rooms, ensure you have the required licenses and components.

Note: Before installing the Poly Solution for Microsoft Teams Rooms, you'll need the following:

- [Required License for Microsoft Teams Rooms](#) on page 11
- [Microsoft Teams Rooms Account](#) on page 11

Choose your system from the list below.

[Poly G10-T for Microsoft Teams Rooms](#) on page 6

[Poly G40-T for Microsoft Teams Rooms](#) on page 8

[Poly G85-T for Microsoft Teams Rooms](#) on page 9

Poly G10-T for Microsoft Teams Rooms

Set up instructions for your Poly G10-T Microsoft Teams Room.

Poly G10-T Components

Note: Before installing the Poly Solution for Microsoft Teams Rooms, you'll need the following:

- [Required License for Microsoft Teams Rooms](#) on page 11
 - [Microsoft Teams Rooms Account](#) on page 11
-



- Poly GC8 touch controller
- Lenovo Device
- 10m fiber-optic USB
- PC wall mount kit (optional)

Required Tools

- Phillips #1 screwdriver
- Flathead screwdriver

Additional Required Components

- HDMI cable(s)
- USB Keyboard and mouse (for installation only)

Installation Instructions

For instruction on installing the PC wall mount kit, see the instructions included in the box.

For a complete cabling diagram, see [Poly G10-T Cabling Diagram](#) on page 27.

1. See [Prepare your environment for Microsoft Teams Rooms](#) on the Microsoft website.
2. Verify that you have the required license. See [Teams Meeting Room Licensing](#) on the Microsoft website.
3. [Cable the Poly Solution for Microsoft Teams Rooms](#)
 - a. [Connect the Poly GC8 to the Lenovo device.](#)
 - b. [Connect a Supported Camera to the system.](#)
 - c. [Connect one or two monitors to the system.](#)
 - d. [Connect the computer to your network.](#)
4. [Power On and Set Up Your Microsoft Teams Rooms Solution](#) on page 21
 - a. [Power on the components and complete Windows setup.](#)
 - b. [Complete the Microsoft Teams Rooms out-of-box setup.](#)
 - c. [Access additional settings.](#)
 - d. [Enable Dual Monitor mode.](#)

- e. [Update the computer.](#)

Microsoft Teams Rooms User Information

For information on using Microsoft Teams Rooms, see [Microsoft Teams Rooms help](#).

Poly G40-T for Microsoft Teams Rooms

Set up instructions for your Poly G40-T Microsoft Teams Room.

Poly G40-T Components

Note: Before installing the Poly Solution for Microsoft Teams Rooms, you'll need the following:

- [Required License for Microsoft Teams Rooms](#) on page 11
 - [Microsoft Teams Rooms Account](#) on page 11
-



Poly G40-T for Microsoft Teams Rooms Components

- Poly GC8 touch controller
- Poly Studio USB Camera
- Lenovo Device
- 10m fiber-optic USB
- PC wall mount kit (optional)

Required Tools

- Phillips #1 screwdriver
- Flathead screwdriver

Additional Required Components

- HDMI cable(s)
- USB Keyboard and mouse (for installation only)

Installation Instructions

For instruction on installing the PC wall mount kit, see the instructions included in the box.

For a complete diagram, see [Poly G40-T Cabling Diagram](#) on page 28.

1. See [Prepare your environment for Microsoft Teams Rooms](#) on the Microsoft website.
2. Verify that you have the required license. See [Teams Meeting Room Licensing](#) on the Microsoft website.
3. [Cable the Poly Solution for Microsoft Teams Rooms](#).
 - a. [Connect the Poly GC8 to the Lenovo device](#).
 - b. [Connect a Studio USB camera to the system](#).
 - c. [Connect one or two monitors to the system](#).
 - d. [Connect the computer to your network](#).
4. [Power On and Set Up Your Microsoft Teams Rooms Solution](#) on page 21
 - a. [Power on the components and complete Windows setup](#).
 - b. [Complete the Microsoft Teams Rooms out-of-box setup](#).
 - c. [Access additional settings](#).
 - d. [Enable Dual Monitor mode](#).
 - e. [Update the computer](#).

Microsoft Teams Rooms User Information

For information on using Microsoft Teams Rooms, see [Microsoft Teams Rooms help](#).

Poly G85-T for Microsoft Teams Rooms

Set up information for your Poly G85-T Microsoft Teams Rooms.

Poly G85-T Components

Note: Before installing the Poly Solution for Microsoft Teams Rooms, you'll need the following:

- [Required License for Microsoft Teams Rooms](#) on page 11
- [Microsoft Teams Rooms Account](#) on page 11



- Poly GC8 touch controller
- Poly EagleEye Director II camera
- Lenovo Device
- 10m fiber-optic USB
- PC wall mount kit (optional)

Required Tools

- Phillips #1 screwdriver
- Flathead screwdriver

Additional Required Components

- HDMI cable(s)
- USB Keyboard and mouse (for installation only)

Installation Instructions

For instruction on installing the PC wall mount kit, see the instructions included in the box.

For a complete cabling diagram, see [Poly G85-T Cabling Diagram](#) on page 28.

1. See [Prepare your environment for Microsoft Teams Rooms](#) on the Microsoft website.
2. Verify that you have the required license. See [Teams Meeting Room Licensing](#) on the Microsoft website.
3. [Cable your Poly Solution for Microsoft Teams Rooms](#)
 - a. [Connect the Poly GC8 to the Lenovo device.](#)
 - b. [Connect an EagleEye Director II to the system.](#)
 - c. [Connect one or two monitors to the system.](#)
 - d. [Connect the computer to your network.](#)
4. [Power On and Set Up Your Microsoft Teams Rooms Solution](#) on page 21
 - a. [Power on the components and complete Windows setup.](#)
 - b. [Complete the Microsoft Teams Rooms out-of-box setup.](#)

- c. [Access additional settings.](#)
- d. [Enable Dual Monitor mode.](#)
- e. [Update the computer.](#)

Microsoft Teams Rooms User Information

For information on using Microsoft Teams Rooms, see [Microsoft Teams Rooms help](#).

Required Microsoft Licenses and Accounts

Make sure you have the following licenses and accounts:

- Microsoft Teams Rooms license
- Your Microsoft Teams Rooms account credentials

Required License for Microsoft Teams Rooms

You'll need a Microsoft Teams Rooms license from Microsoft to set up your Poly Solution for Microsoft Teams Rooms.

For information on required licenses and dependencies, see the Microsoft Teams documentation.

[Teams Meeting Room Licensing](#)

Microsoft Teams Rooms Account

To set up your Poly Microsoft Teams Rooms solution, you'll need a Microsoft Teams Rooms account.

For information on setting up your Microsoft Teams Rooms account, see the Microsoft Teams documentation.

[Configure accounts for Microsoft Teams Rooms](#)

Cable the Poly Solution for Microsoft Teams Rooms

Topics:

- [Connect the Poly GC8 to the Lenovo device](#)
- [Connect a USB Camera to the System](#)
- [Connect the Poly Studio USB Video Bar to the Lenovo device](#)
- [Connect an EagleEye Director II to a Microsoft Teams Rooms System](#)
- [Connect One or Two Monitors to the System](#)
- [Connect the Computer to the Network](#)

Cable the Poly GC8, the Lenovo device, the camera, and displays.

Procedure

1. [Connect the Poly GC8 to the Lenovo device](#)
2. Connect a camera to the system. Choose from:
 - [Connect a USB Camera to the system.](#)
 - [Connect a Poly Studio USB video bar to the system.](#)
 - [Connect an EagleEye Director II to the system.](#)
3. [Connect one or two monitors to the system.](#)
4. [Connect the computer to the network.](#)

Connect the Poly GC8 to the Lenovo device

Connect the cables to the Poly GC8 and the Lenovo device.

Important: Don't plug in or power on any components until you've connected all cables to the Poly GC8 or Lenovo device.

Procedure

1. Remove the back cover of the Poly GC8.
 - a. Loosen the bottom panel screw using a #1 Phillips-head screwdriver.

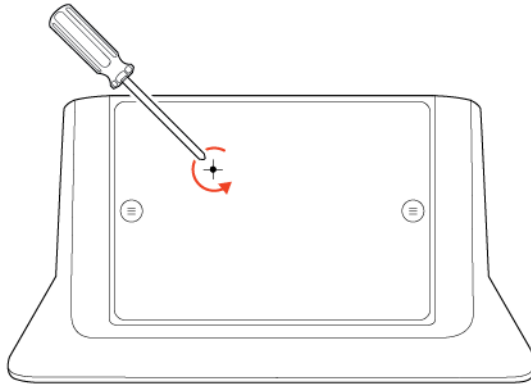

- b.** Press rubber circles located on the left and right side of the bottom panel and slide the panel up to remove it.

If the retaining screw causes the cover to seem stuck, try one of the following:

- Turn the Poly GC8 so the bottom panel is facing down as you slide off the bottom panel.
- Push up with one hand while using the screwdriver to turn the retaining screw counterclockwise.

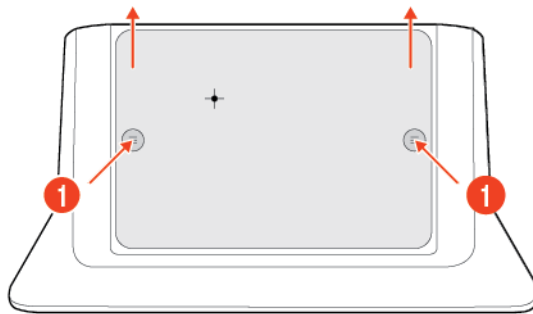

- c.** Using a flathead screwdriver, loosen the cable guard screw and remove the cable guard.

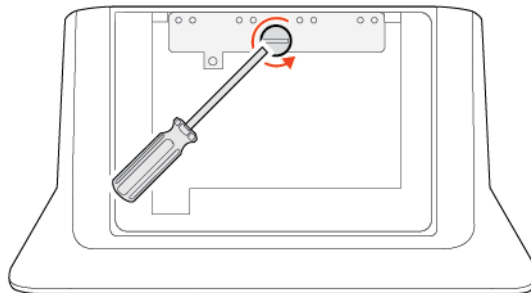

2. Connect the cables to the Poly GC8.

- Connect the USB-C connector of the supplied USB-A to USB-C cable to the Poly GC8.
- Connect the power cable to the Poly GC8.

- c. If you want to allow users to share content in a conference, connect the mini-HDMI connector of the mini-HDMI to HDMI cable to the Poly GC8.

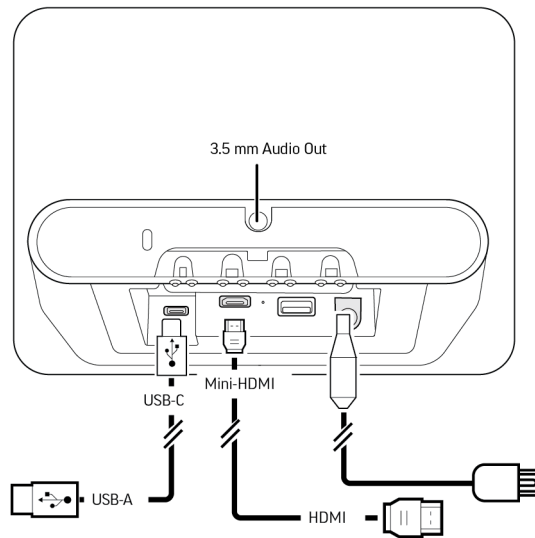

- d. Connect the GC8 3.5 mm audio out connection to an audio output device.
3. Reattach the cable guard and the bottom panel.

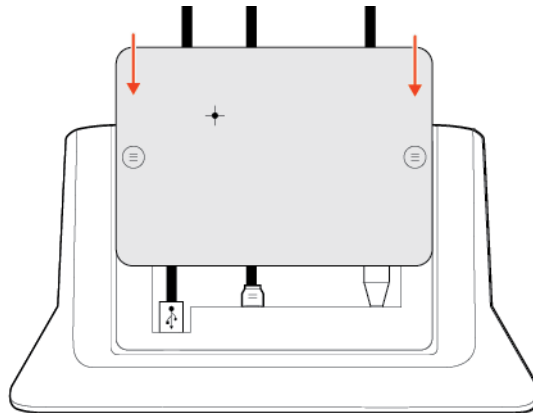

4. Connect the USB-A connector of the USB-A to USB-C cable to the Lenovo device.

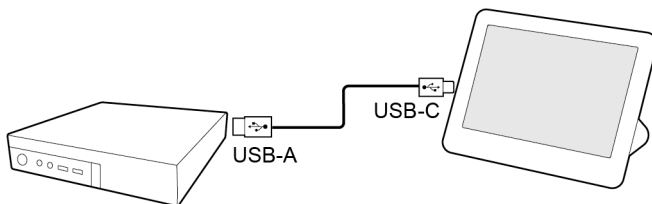

5. Choose the camera included in your kit.
- Poly G10-T - [Connect a Supported Camera to the system](#)
 - Poly G40-T - [Connect a Studio USB camera to the system.](#)
 - Poly G85-T - [Connect an EagleEye Director II to the system.](#)

Connect a USB Camera to the System

Connect any supported camera to the Poly Solution for Microsoft Teams Rooms.

Important: Do not plug in or power on any components until you have connected all cables to the Poly GC8 or Lenovo device.

Procedure

- » Using the cable that was supplied with the camera, cable the camera to the Lenovo device.
After connecting the camera, see [Connect One or Two Monitors to the System..](#)

Connect the Poly Studio USB Video Bar to the Lenovo device

Connect the camera to the Lenovo device to add a video camera, microphones, and speakers for video conferencing.

Important: Don't plug in or power on any components until you've connected all cables to the GC8 or Lenovo device.

Note: If your system includes a Poly EagleEye Director II camera, see [Connect an EagleEye Director II to a Microsoft Teams Rooms System](#) on page 15.

Procedure

1. Connect the USB-C connector of the supplied USB-A to USB-C cable to the camera.
2. Connect the USB-A connector to the Lenovo device.

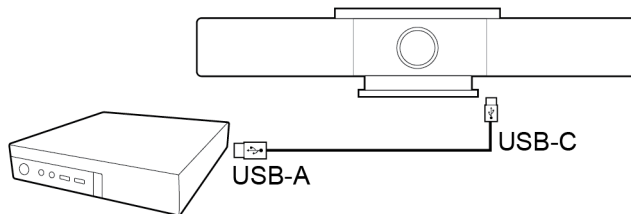

3. Connect the power cable.
After connecting the camera, see [Connect One or Two Monitors to the System..](#)

Connect an EagleEye Director II to a Microsoft Teams Rooms System

Connect the Poly EagleEye Director II to the Lenovo device.

Important: Don't plug in or power on any components until you've connected all cables to the GC8 or Lenovo device.

Procedure

1. Connect the EagleEye Director II to the computer.
 - a. Connect the USB-B connector of the supplied USB-A to USB-B cable to the camera.
 - b. Connect the USB-A connector to the Lenovo device.

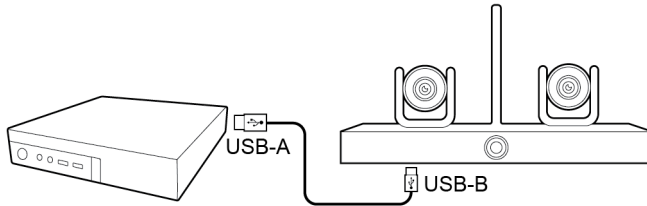

2. Choose from the following optional components:
 - [Connect a Poly Trio to the Microsoft Teams Room Solution.](#)
 - [Connect the EagleEye Director II to a mono DSP.](#)
 - [Connect the EagleEye Director II to a stereo DSP.](#)

Connect a Poly Trio to the Microsoft Teams Rooms Solution

You can pair an EagleEye Director II with a Poly Trio (not included) and use the Poly Trio speakers and microphones with your solution.

Configure the Poly EagleEye Director II. For more information, see the *Polycom EagleEye Director II Setup Sheet*.

Note: To connect a Poly Trio to your Poly G85-T Microsoft Teams Rooms solution, connect the EagleEye Director II to your network.

Once paired and configured, the Trio system adds Acoustic Echo Cancellation (AEC) functionality that enables the EagleEye Director II camera to ignore audio output from the Trio system speakers. This results in better EagleEye Director II camera tracking.

For information on pairing and configuring, see the *Poly Trio Systems in Microsoft Environments Administrator Guide* and *Polycom EagleEye Director II Setup Sheet* on [Polycom Support website](#).

Procedure

1. Connect a micro-USB to USB-A cable from the Poly Trio to the Poly GC8.
2. Connect the Poly Trio to a PoE-enabled Ethernet connection.
3. Set the Poly Trio to the **Microsoft USB Optimized** base profile.
4. Go to **Settings > Advanced**.
5. Enter the administrator password.
6. Select **Network Devices**.
7. Under **Available Devices**, select the EagleEye Director II.
8. Select **Pair**.
9. Select **Complete**.

After connecting the Poly Trio, see [Connect One or Two Monitors to the System](#).

Connect a Poly Supported Mono DSP to the EagleEye Director II

When using an EagleEye Director II as your camera, you can connect the system to a Poly-supported mono DSP.

Procedure

1. Connect the Poly-supported DSP to the Lenovo device using a USB cable.
2. Connect the DSP to the EagleEye Director II using a 3.5 mm audio cable.
3. Connect a microphone and speaker system to the Poly-supported DSP.

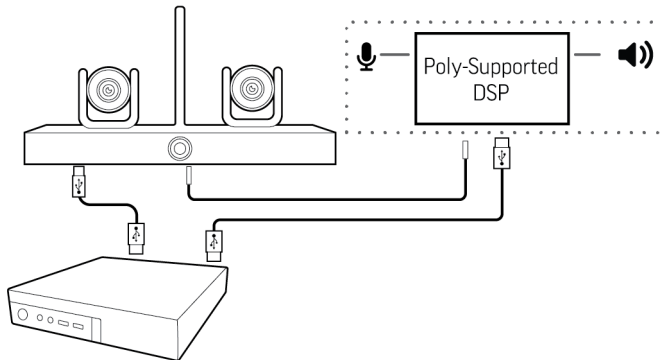

4. The A/V integrator must route the far end audio to the EagleEye Director II.

Figure 1: EagleEye Director II Far Audio Reference Cable - Mono

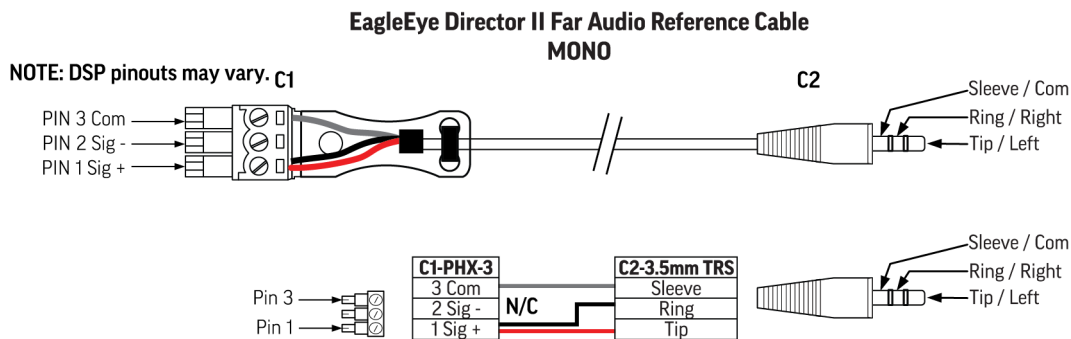

- The camera system uses a 3.5 mm TRS audio connector for the Far Audio Reference input. For a mono configuration, the system uses a single DSP or Phoenix connector. For stereo configurations, the system uses two DSP or Phoenix connectors.
- The TRS connector consists of the:
 - Sleeve/common (section of the connector post closest to the base)
 - Ring/right (in the middle of the connector post)
 - Tip/left (at the end of the connector post)
- At the 3.5mm TRS connector, connect one conductor of a shielded twisted-pair audio cable to the tip/left terminal and the other to the ring/right terminal. The tip carries left audio and the ring carries right audio. Connect the shield or drain wire to the sleeve/common terminal.

- At the DSP or Phoenix connector, connect both conductors of the shielded twisted-pair audio cable to the pin 1 or device appropriate signal positive position. Connect the shield or drain wire to the pin 3 or device appropriate ground/common position. Connect nothing to the pin 2 or device appropriate signal negative position.
- Connect a shield or drain wire to the pin 3 or device appropriate ground/common position. Connect nothing to the pin 2 or device appropriate signal negative position.

After connecting the DSP, see [Connect One or Two Monitors to the System](#).

Connect a Poly Supported Stereo DSP to the EagleEye Director II

When using an EagleEye Director II as your camera, you can connect the system to a Poly-supported stereo DSP.

Procedure

1. Connect the Poly-supported DSP to the Lenovo device using a USB cable.
2. Connect the DSP to the EagleEye Director II using a 3.5 mm audio cable.
3. Connect a microphone and speaker system to the Poly-supported DSP.

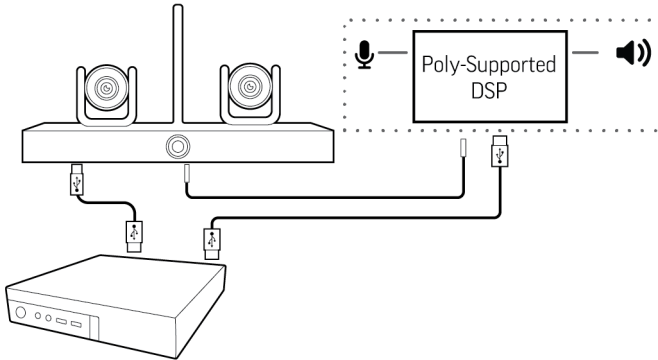

4. The A/V integrator must route the far end audio to the EagleEye Director II.

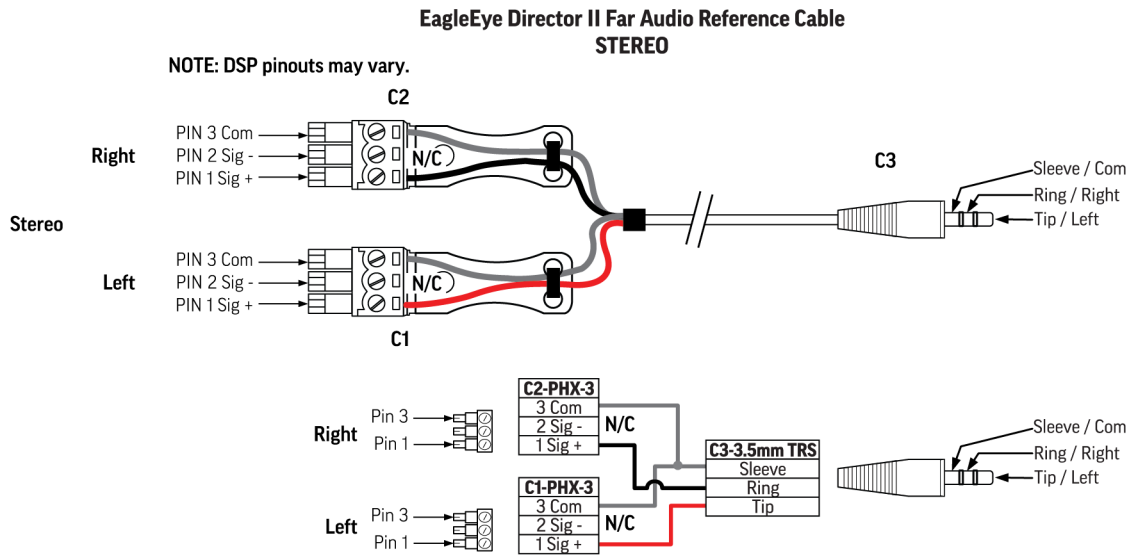
Figure 2: EagleEye Director II Far Audio Reference Cable - Stereo

The camera system uses a 3.5 mm TRS audio connector for the Far Audio Reference input and two DSP or Phoenix connectors.

The TRS connector consists of:

- Sleeve/common (section of the connector post closest to the base)
- Ring/right (in the middle of the connector post)
- Tip/left (at the end of the connector post)

Note that the DSP pinouts may vary. The most common arrangement is that the pins per port on the DSP or Phoenix connector are (left to right) pin 1: signal positive, pin 2: signal negative, and pin 3: ground/common.

At the 3.5mm TRS connector, connect one conductor of a shielded twisted-pair audio cable to the tip/left terminal and the other to the ring/right terminal. The tip carries left audio and the ring carries right audio. Connect the shield or drain wire to the sleeve/common terminal.

At the DSP or Phoenix connector for the left signal, connect the conductor of the shielded twisted-pair audio cable that's connected to the tip/left of the 3.5 mm TRS connector to the pin 1 or device appropriate signal positive position. Connect a shield or drain wire to the pin 3 or device appropriate ground/common position. Connect nothing to the pin 2 or device appropriate signal negative position.

At the DSP or Phoenix connector for the right signal, connect the conductor of the shielded twisted-pair audio cable that's connected to the ring/right of the 3.5 mm TRS connector to the pin 1 or device appropriate signal positive position. Connect a shield or drain wire to the pin 3 or device appropriate ground/common position. Connect nothing to the pin 2 or device appropriate signal negative position.

After connecting the DSP, see [Connect One or Two Monitors to the System](#).

Connect One or Two Monitors to the System

You can connect one or two monitors to the system to display far-side video and content.

Important: Don't plug in or power on any components until you've connected all cables to the Poly GC8 or Lenovo device.

Procedure

1. Connect one end of the HDMI cable to the Lenovo device.
2. Connect the other end of the HDMI cable to the monitor.

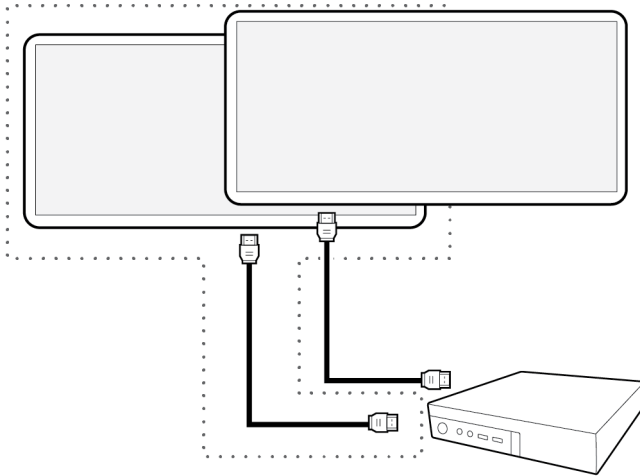

Connect the Computer to the Network

Connect the Lenovo device to your network using an Ethernet cable.

Note: Microsoft Teams Room doesn't support wireless video conferencing.

Procedure

1. Using an Ethernet cable, connect the Lenovo device to an Ethernet port.
2. [Power on and set up your Microsoft Teams Rooms solution.](#)

Power On and Set Up Your Microsoft Teams Rooms Solution

Topics:

- [Power on the Components and Complete Windows Setup](#)
- [Complete the Microsoft Teams Rooms Out-of-Box Setup](#)
- [Access Additional Settings](#)
- [Enable Dual Monitor Mode](#)
- [Update the Computer](#)

After cabling the system, power on all the components complete the out-of-box setup.

Procedure

1. [Power on the components and complete Windows setup.](#)
2. [Complete the Microsoft Teams Rooms out-of-box setup.](#)
3. [Access additional settings.](#)
4. [Enable Dual Monitor mode.](#)
5. [Update the computer.](#)

Power on the Components and Complete Windows Setup

After cabling your Microsoft Teams Rooms system, power on the devices and configure Microsoft Teams Rooms.

Procedure

1. Connect a USB keyboard and mouse to the Lenovo device.

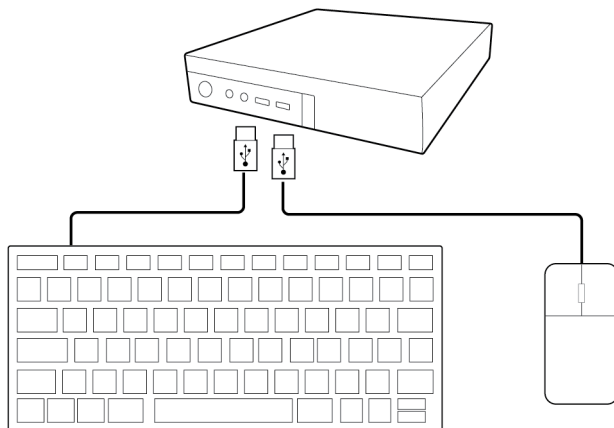

2. Plug in and power on the Poly GC8 and then plug in and power on the other components.
The Lenovo device may reboot more than once as it downloads and installs updates.

Caution: Don't shut down the Lenovo device during this process.

3. Complete the Windows Out-of-Box setup.
 - a. Accept the Microsoft Software License Terms.
 - b. Enter your Microsoft Teams Rooms account information.
 See [Initial set up of the console](#) on the Microsoft website.
 - a. Choose your region.
 - b. Choose your keyboard layout.
 - c. When prompted to add a second keyboard layout, select **Skip**.

Complete the Microsoft Teams Rooms Out-of-Box Setup

When you first start the system, the Microsoft Teams Rooms out-of-box screen appears.

Note: Before installing the Poly Solution for Microsoft Teams Rooms, you'll need the following:

- [Required License for Microsoft Teams Rooms](#) on page 11
 - [Microsoft Teams Rooms Account](#) on page 11
-

Complete your configuration. For detailed instructions, see [Initial Setup for Microsoft Teams Rooms](#) on the Microsoft website.

Procedure

1. Accept the Microsoft Software License Terms.
2. Enter your Microsoft Teams Rooms account information.
See [Configure accounts for Microsoft Teams Rooms](#).
3. Select the appropriate **Supported Meeting Mode** based on your preferred default application.
 - Skype for Business (default) and Microsoft Teams
 - Skype for Business and Microsoft Teams (default)
 - Skype for Business only
4. Enable **Modern Authentication**.
5. If your mailbox has an alternate SMTP, complete Exchange sign-in.
6. Select **Finish**.

The system restarts.

The Lenovo device may reboot more than once as it downloads and installs updates. Do not shut down the Lenovo device during this process. When complete, the Microsoft Teams Rooms Setup screen appears on the Poly GC8.

7. Choose from the following:
 - To configure additional settings, see [Access Additional Settings](#).

- To configure a dual monitor setup, see [Enable Dual Monitor Mode](#).
8. [Update the Computer](#) on page 23.

Access Additional Settings

Access the **Settings** menu to configure additional settings.

Procedure

1. On the Poly GC8, select **More > Settings**.
2. Enter the admin password.
The default admin password is `sfb`.
3. Correct or change the email password if necessary.
4. Change the audio device.
Speaker for Conferencing and **Default Speaker** are the same.
5. Connect a content camera and configure the "magic whiteboard" functionality.

When using the "magic whiteboard" functionality, you can configure content cameras.

Note: The content camera isn't the People camera. Microsoft Teams Rooms application automatically sets the people camera.

For more information, see [Content camera for Microsoft Teams Rooms](#).

Enable Dual Monitor Mode

If you connected a second monitor, enable **Dual monitor mode** in the Microsoft Teams Rooms settings.

Procedure

1. From the Microsoft Teams Rooms interface on the Poly GC8, select **More > Settings**.
2. Enter the admin password.
The default admin password is `sfb`.
3. Select **Device**.
4. Enable **Dual monitor mode**.
The Lenovo device reboots.

Update the Computer

After connecting all peripherals to the system, perform a Windows Update.

When the Poly GC8 requires updates, the screen turns black while the firmware is updating, which can take up to 5 minutes. After the firmware updates, the Poly GC8 restarts and returns to regular operation automatically.

Procedure

1. On the Poly GC8, select **More > Settings**.

2. Enter the admin password.
The default admin password is `sfb`.
3. Select **Windows Settings**.
4. Select **Administrator**.
5. Enter the administrator password.
The default admin password is `sfb`.
6. Run Windows Update and install all available updates.
This will update the computer and all attached peripherals.

System Maintenance

Topics:

- [Automatic Microsoft Teams Rooms System Updates](#)
- [Manually Updating the Microsoft Teams Room Application](#)
- [Access Windows on the Lenovo Device](#)
- [Factory Restore the Poly GC8](#)
- [Factory Reset the Poly GC8](#)

Automatic Microsoft Teams Rooms System Updates

By default, the system automatically downloads and installs updates for Windows, Microsoft Teams Rooms, and attached peripherals.

Windows Update runs at a set time each night to download available updates. Leave the system on overnight to ensure that the system can receive and install updates.

For information on Microsoft Teams Rooms releases, see [Microsoft Teams Rooms Release Notes](#).

Manually Updating the Microsoft Teams Room Application

You can manually update the Microsoft Teams Room application through the Microsoft Store application.

For information on manually updating the Microsoft Teams Rooms application see, [Manually update a Microsoft Teams Room device](#) on the Microsoft website.

Access Windows on the Lenovo Device

You can access Windows on the Lenovo device to configure Windows settings, manually update Windows, or manually update the Microsoft Teams Room app.

Procedure

1. On the Lenovo device, select **More > Settings**.
2. Enter the admin password.
The default admin password is `sfb`.
3. Select **Windows Settings**.
4. Select **Administrator**.
5. Enter the admin password.
The default admin password is `sfb`.

6. To return to the Microsoft Teams Rooms interface, sign out of the administrator account and select the **Skype** account and select **Sign in**.

Factory Restore the Poly GC8

Factory restore erases all Poly GC8 data and restores the device to the original factory build.

Procedure

1. With the Poly GC8 powered off, use a paperclip to press and hold the reset button.

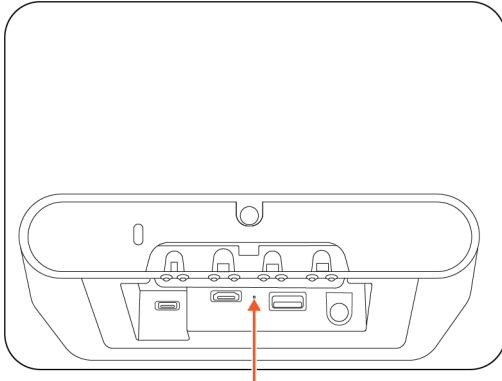

2. While holding the reset button, power on the Poly GC8.
 3. Hold the reset button for three seconds as the Poly GC8 powers on.
- The Poly GC8 erases all settings and returns to the original factory software build.

Factory Reset the Poly GC8

Factory reset wipes out all data on the device and restores the default settings.

Factor reset is performed while the Poly GC8 is powered on.

Procedure

- » With the Poly GC8 powered on, use a paperclip to press and hold the reset button.

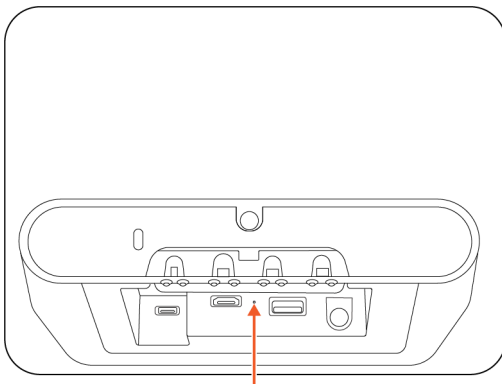

The Poly GC8 reboots and all data is reset to default settings.

Poly Solutions for Microsoft Teams Rooms Cabling Diagrams

Topics:

- [Poly G10-T Cabling Diagram](#)
- [Poly G40-T Cabling Diagram](#)
- [Poly G85-T Cabling Diagram](#)

Use the cabling diagrams to see the complete cabling for all devices in your Poly Solution for Microsoft Teams Rooms.

Poly G10-T Cabling Diagram

Complete cabling diagram for the Poly G10-T.

Important: Don't plug in or power on any components until you've connected all of the components together.

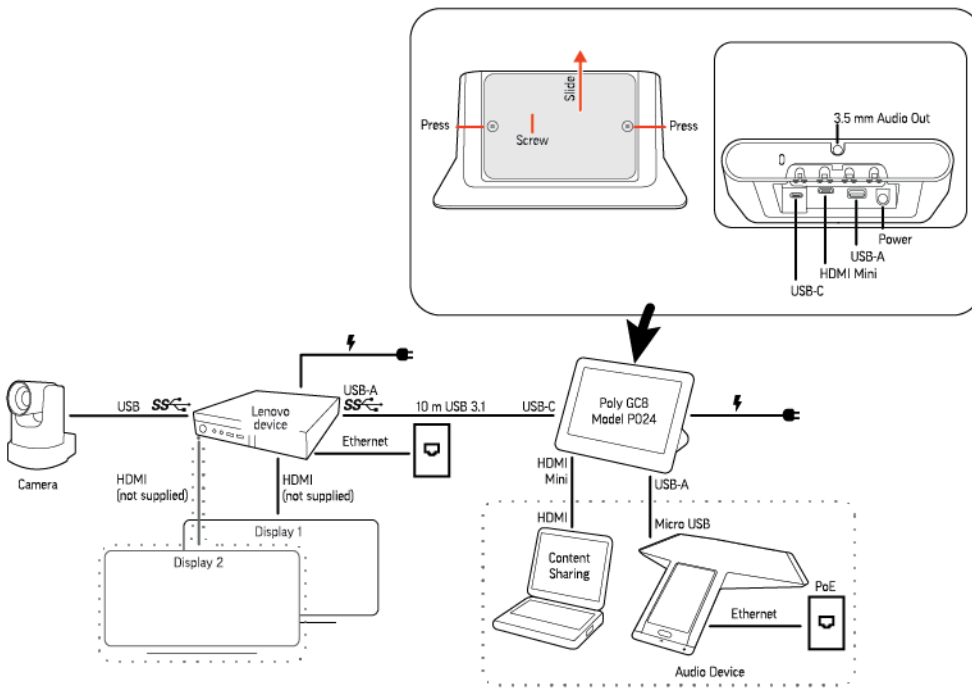

Mouse over and select the image to enlarge it.

Poly G40-T Cabling Diagram

Complete cabling diagram for the Poly G40-T.

Important: Don't plug in or power on any components until you've connected all of the components together.

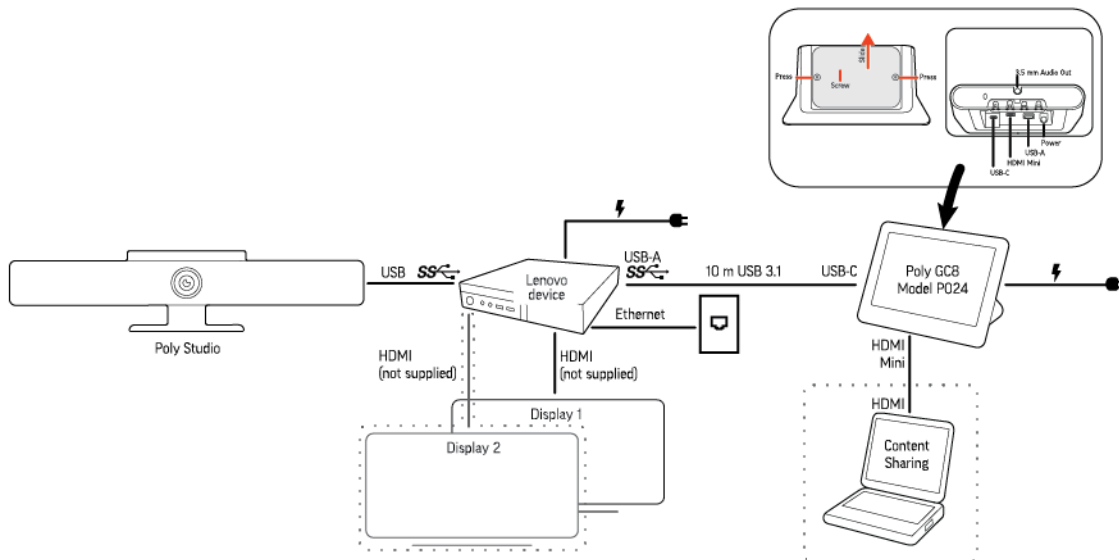

Mouse over and select the image to enlarge it.

Poly G85-T Cabling Diagram

Complete cabling diagram for the Poly G85-T.

Important: Don't plug in or power on any components until you've connected all of the components together.

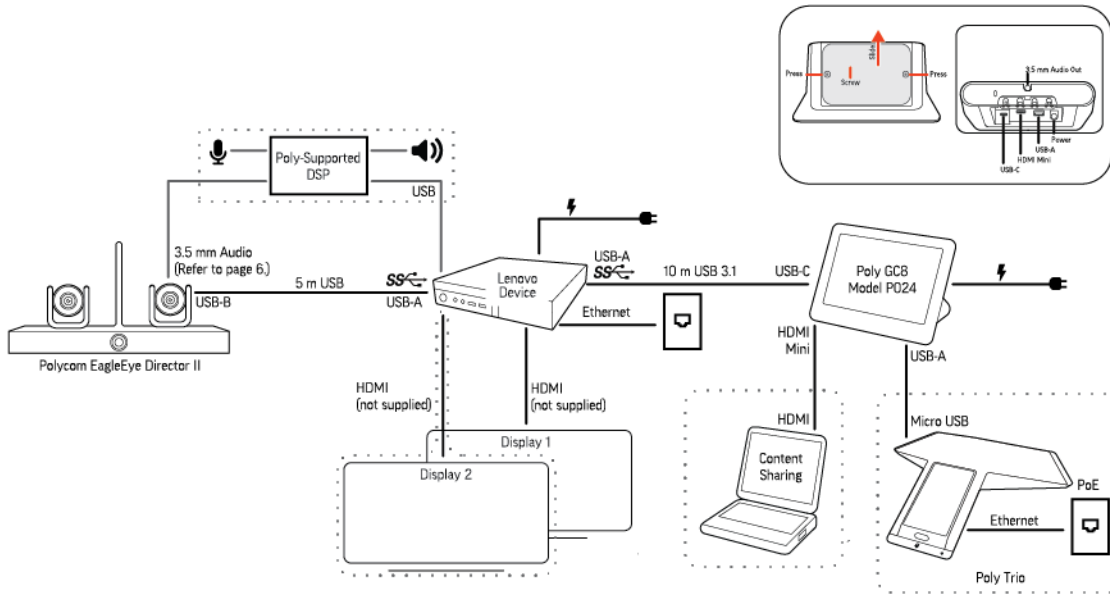

Mouse over and select the image to enlarge it.