

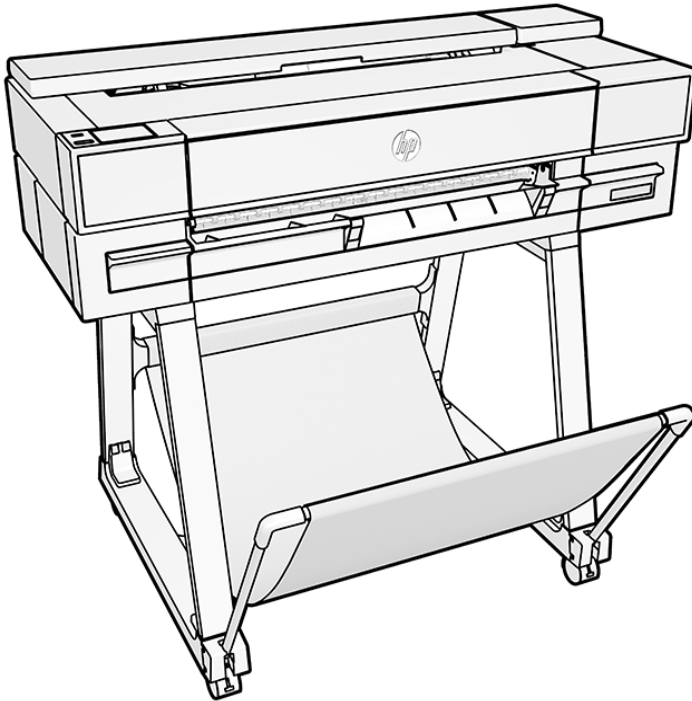

**Setup Guide**  
HP DesignJet T870 printer



# Recommendations for assembling the printer



**Printer overall process can take up to 120 minutes.**

**Please read these instructions carefully.**

These instructions explain the steps to assemble the printer. The icons used in this document are also located on the printer packaging to help you identify the items needed for each assembly stage.

Extra screws are provided; you may have some left over once assembly is complete.



**IMPORTANT: 3 people are required for step 30.**

Before unpacking the final location of the assembled product, ensure there is sufficient clearance around the product as shown in the illustration below.

To assemble, prepare a clear floor area of least 3 m x 3 m (118 in x 118 in).

## Product working area

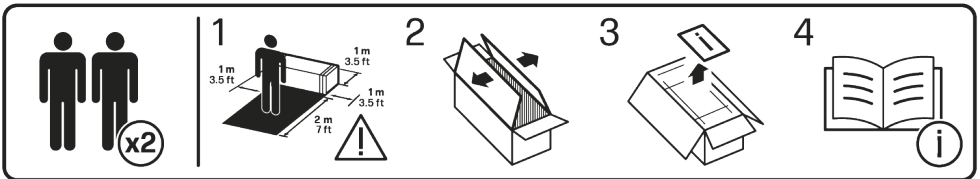

## Accessibility Recommendations

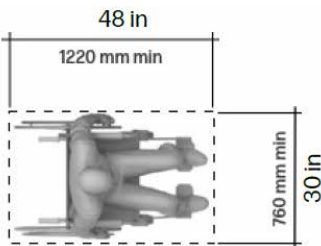

To ensure an accessible operating area for the printer, leave a minimum clear space of 760 mm (30 inches) by 1,220 mm (48 inches) with an even level around the sides of the printer.

Light reflection (glare) could affect the readability of the control panel, to improve the visibility, select the most suitable theme (dark-light) on the control panel.

# Printer Assembly

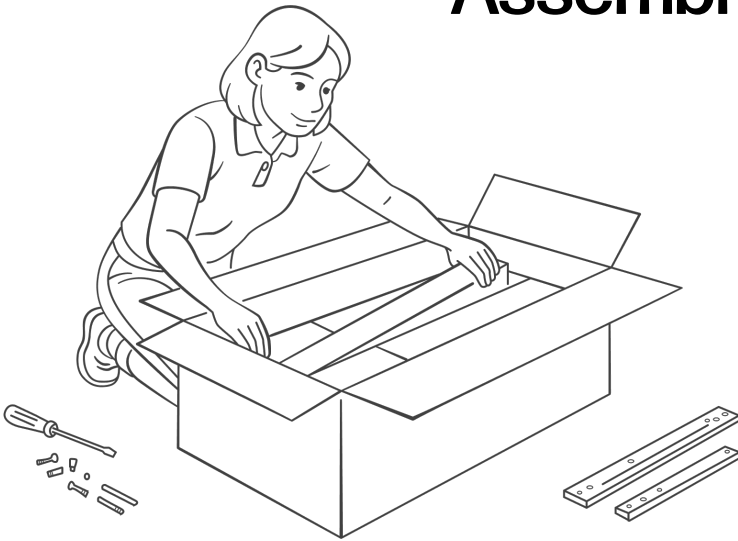

# Printer components

## HP DesignJet T870

### Stand Pieces:

- Left bottom cross-connector (A)
- Right bottom cross-connector (B)
- Left front-leg (C)
- Left rear-leg (D)
- Right rear-leg (D)
- Right front-leg (E)
- Bottom cross-tube (F)
- Basket fabric and rear cross tube (G)
- Basket tubes (H)
- Top cross-beam (I)

### Miscellaneous:

- Screwdriver and screws (Z)
- Ink cartridges
- Cable cover
- Power cord

### Documentation:

- Quick Start Flyer

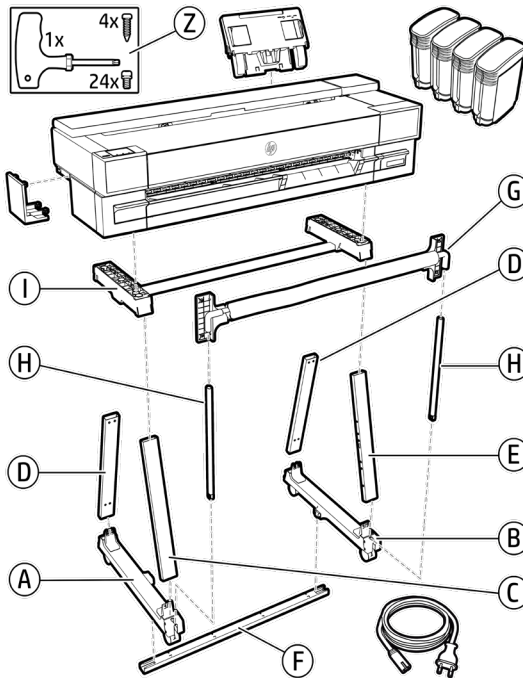

# Printer assembly

## Assemble the stand

1

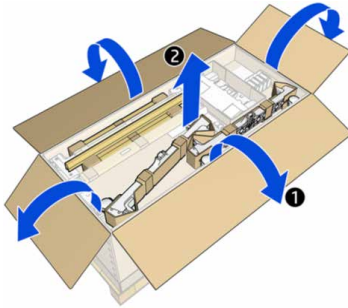

### Remove the pieces



**Important: HP recommends to assembly on a surface that prevents damage.**



**Important: Do not remove the packaging from each part of the stand so you can identify the part with the label letter.**

Open the box and take out the pieces from the in-box material.

2



### Check the tools



**Note: There are extra screws.**

Locate the different types of elements for assembly (Z).

3

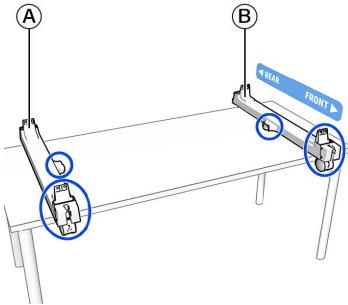

**HP recommends to assembly on a surface that prevents damage.**



**Note: The parts are positioned symmetrically. Place bottom cross-connectors (A and B) on a table with the pins/connectors facing inwards.**

Remove the two bottom cross-connectors (A and B) from the box.

4

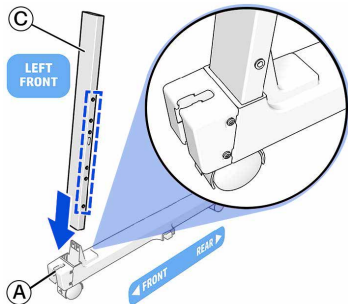

### Assemble the Left Side:



**Note: The holes must face inwards.**

Insert the left front-leg (C) onto the front of the left bottom cross-connector (A).

# Printer assembly

## Assemble the stand

5

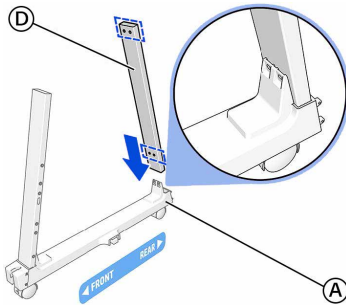

**Note:** The holes furthest from the end must be positioned at the bottom.



**Important:** Ensure that the holes of the legs and connector align.

Insert the left rear-leg (D) onto the rear of the left bottom cross-connector (A).

6

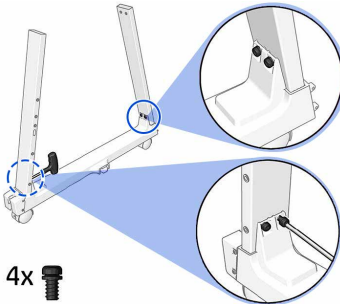

Secure the legs in place with two screws each side.

7

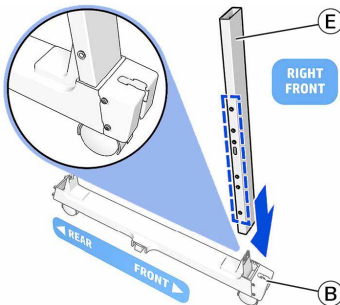

**Assemble the Right Side:**



**Note:** The holes must face inwards.

Insert the right front-leg (E) into the front of the bottom-right cross-connector (B).

8

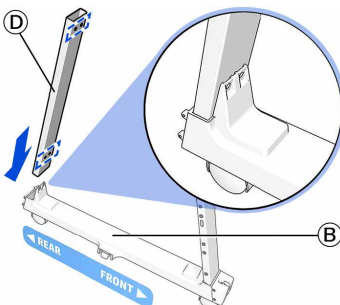

**Note:** The holes furthest from the end must be positioned at the bottom.



**Important:** Ensure that the holes of the legs and connector align.

Insert the rear-right leg (D) onto the rear of the bottom-right cross-connector (B).

# Printer assembly

## Assemble the stand

9

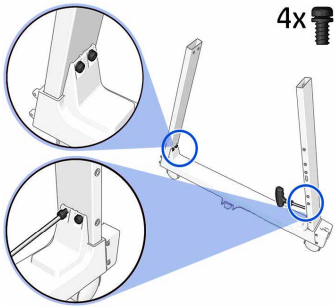

Secure the legs in place with two screws each side.

10

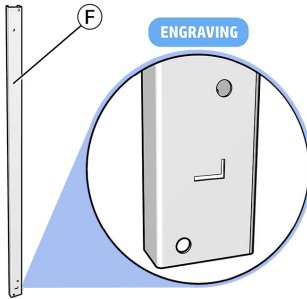

Identify the bottom cross-tube (F).

The holes and the letter "L" must face you.

11

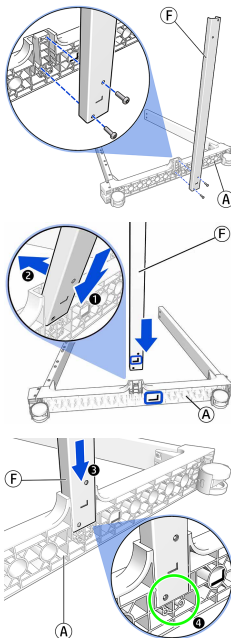

 **IMPORTANT:** Note the position of the holes on the bottom-left cross-connector (A).

Insert the bottom cross-tube (F) diagonally into the slot on the left bottom cross-tube connector (A) and press until fully assembled.

# Printer assembly

## Assemble the stand

12

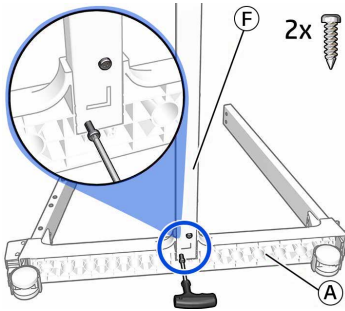

Secure the bottom cross-tube (F) to the bottom-left cross-connector (A) with two screws.

13

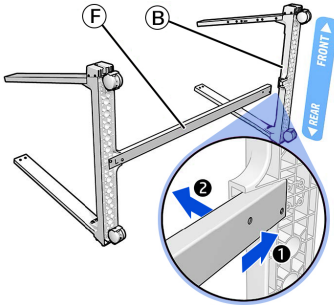

Insert the bottom cross tube (F) diagonally into the bottom-right connector (B).

14

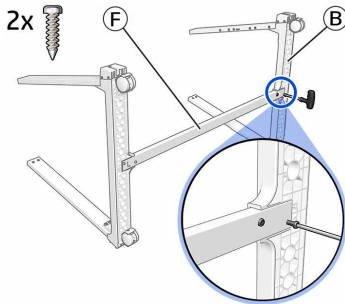

Secure the bottom cross-tube (F) to the right connector (B) with two screws.

15

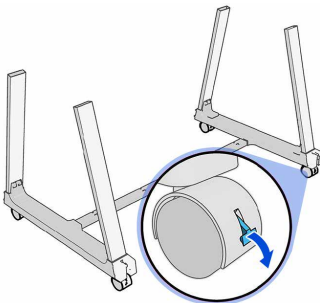

Place the stand upright and **check that the four wheels are locked.**



# Printer assembly

## Assemble the basket

16

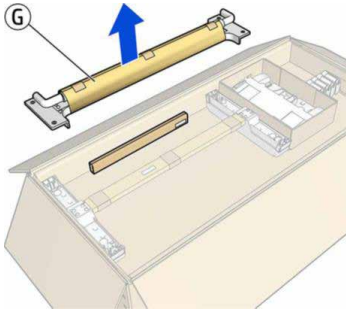

**IMPORTANT:** Do not remove the packaging from the basket rear cross tube.

Locate the basket rear cross tube in the accessory box (G).

17

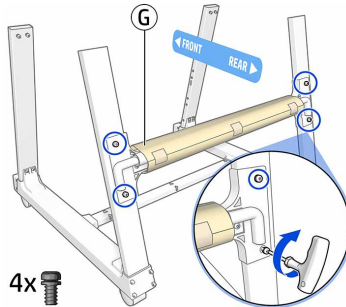

**Note:** Two people are recommended for the assembly.



**Important:** Do not remove the packaging from the basket rear cross tube.

Secure the basket rear cross-tube (G) to the rear legs with two screws each side.

18

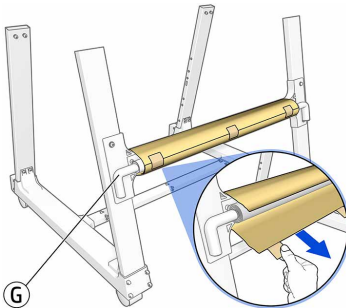

**IMPORTANT:** Don't open the packaging with a cutter or other tool that can damage the part.

Remove the packaging from the basket rear cross-tube (G).

19

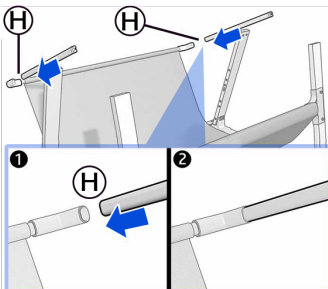

Slot the two tubes into the basket frame (H).

# Printer assembly

## Assemble the basket

20

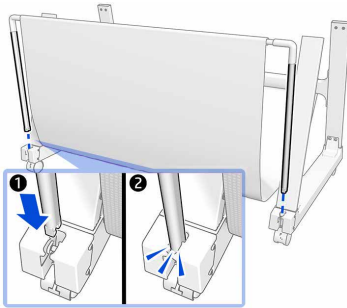

Insert the tubes into the slots at the front of both bottom cross-connectors.

Push them firmly into place until you hear a click.

## Assemble the top cross beam

21

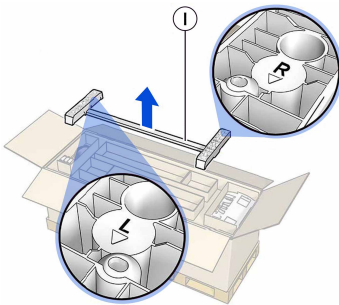

**Note:** There are letters that indicate the left (L) and right (R) side.

Remove the top cross beam (I) from the box.

22

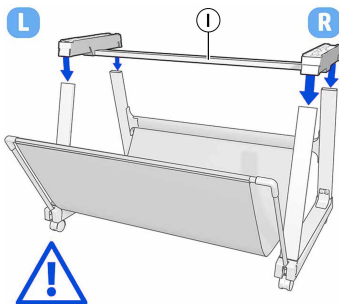

**Note:** There are marks on the plastic that indicate the left (L) and right (R) side.

Ensure that you identify the front and back of the stand.

Position yourself at the front of the stand and carefully connect the top cross-beam (I).

# Printer assembly

## Assemble the top cross beam

23

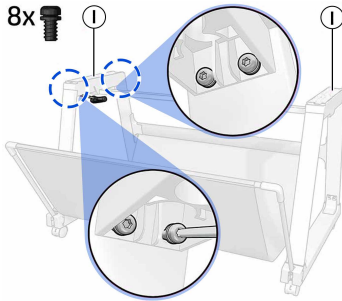

Fix the top cross-beam (1) to the stand with four screws **on the left and right side**.

## Attach the printer body to the stand assembly

24

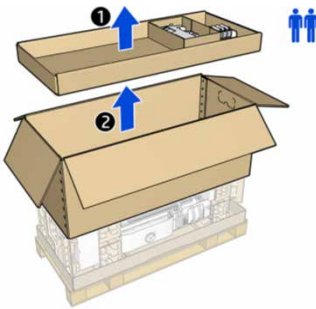

**IMPORTANT: Two people are required.**

Remove the top tray (1).  
Remove the corner tapes (2).  
Lift the box to remove it (3).

25

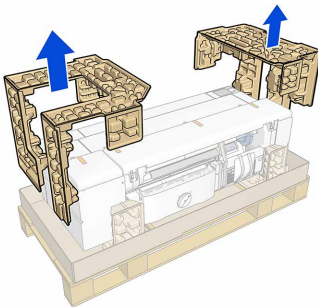

Remove the endcaps.

# Printer assembly

## Attach the printer body to the stand assembly

26

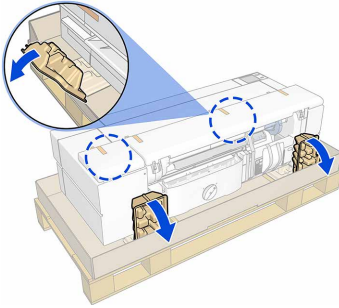

**Cut the corner tapes.**

Lower the bottom endcaps

27

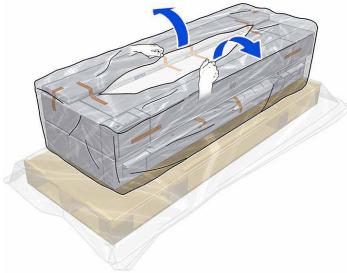

Uncover the printer by tearing open and pulling down the bag.

28

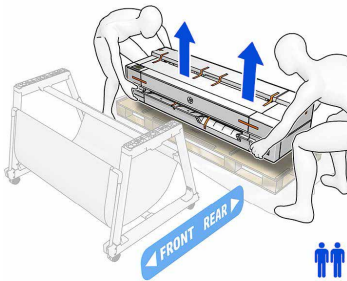

**IMPORTANT: Two people are required.**

Move the printer close to the stand, then with two people, lift the printer body by holding the base.

29

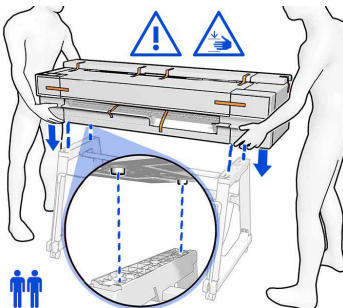

**IMPORTANT: Two people are required.**  
**Take care not to catch your fingers.**

Lower the printer onto the top cross-beam of the stand.

# Printer assembly

## Attach the printer body to the stand assembly

30

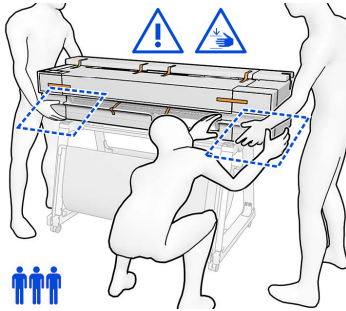

**IMPORTANT: Three people are required. Take care not to catch your fingers.**

Use a third person to adjust the stand position and guide the printer into the correct position.

31

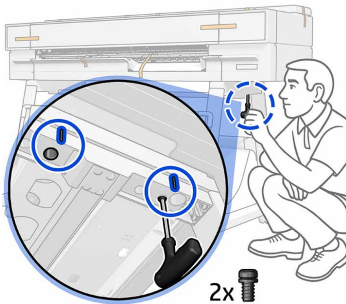

**Note: There are marks on the printer that indicate the position of the screws.**

From underneath, secure the right side of the printer to the stand with two screws.

32

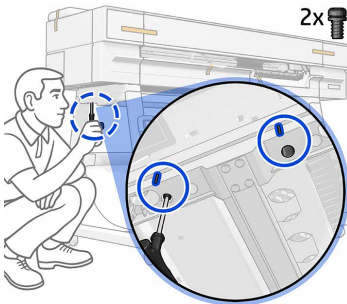

**Note: There are marks on the printer that indicate the position of the screws.**

From underneath, secure the left side of the printer to the stand with two screws.

# Printer assembly

## Remove the tapes and retainers

33

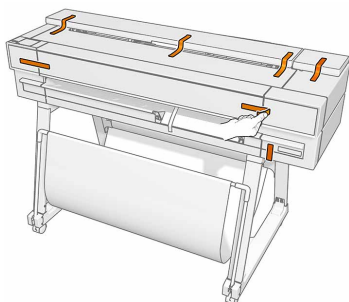

Remove the orange tapes from the top and rear of the printer.

34

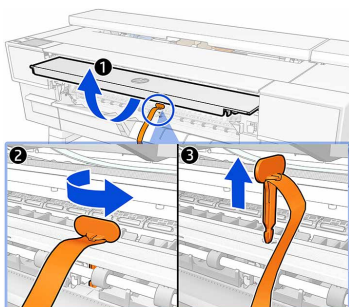

Open the main door. Carefully rotate and remove the pin from inside of the printer.

35

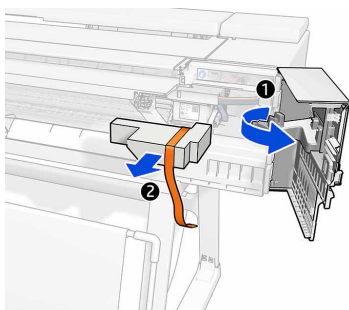

Open the printer carriage door and remove the carton.

# Printer assembly

## Remove the tapes and retainers

36

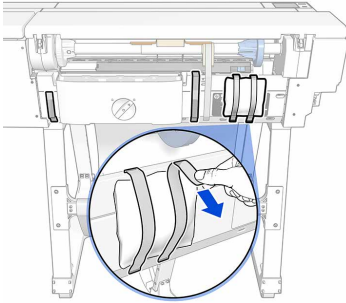

Remove the tapes and desiccant bag.

37

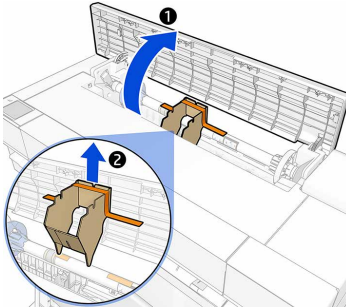

Remove the tape and retainer.  
Close the roll cover.

38

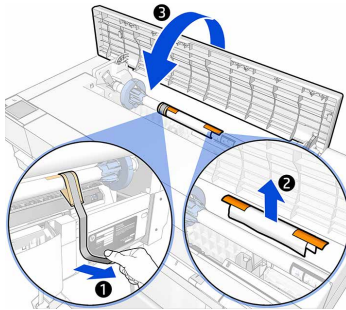

Open the roll cover and remove the tape.

# Printer assembly

## Install the tray

39

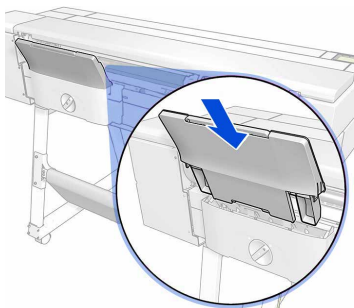

Install the tray.

## Attach the HP Virtual Assistant label

40

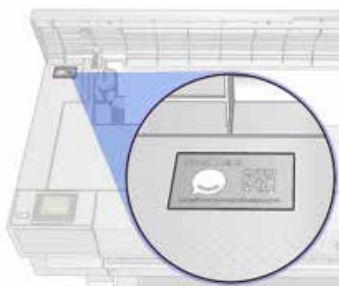

**Note:** Attach the label to the printer in a place where it can be easily seen.

Get the HP Virtual Assistant label from its envelop.

41



HP's Virtual Assistant is always there to troubleshoot issues at any time.



# Printer Setup

After assembling, turn on your printer and follow the on-screen steps.

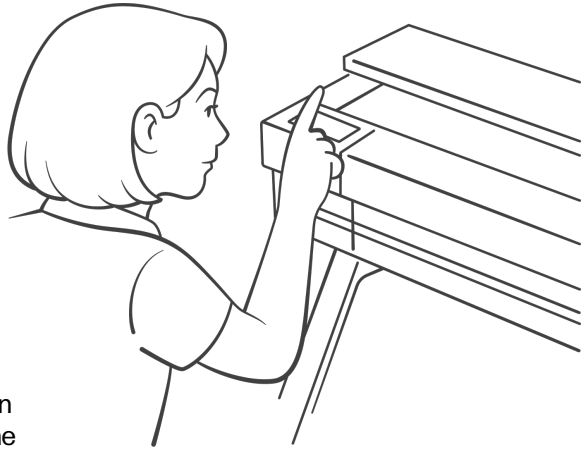

# Printer setup

1

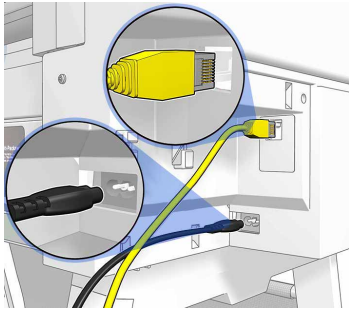

**Note:** If you prefer to use Wi-Fi, there is no need to connect the LAN cable. Follow the instructions on the control panel.

Connect the power cable. Connect a LAN cable (not included) for a wired connection.

2

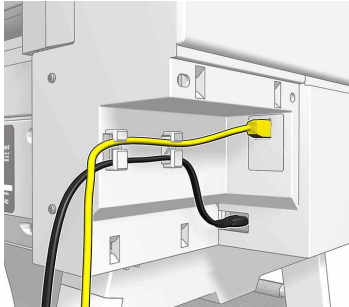

Route the ethernet and power cables through the cable clips.

3

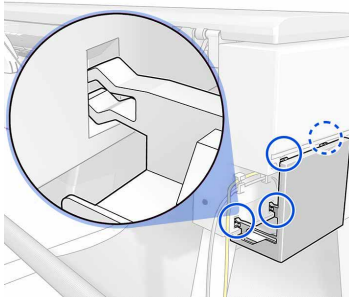

Install the cable cover.

4

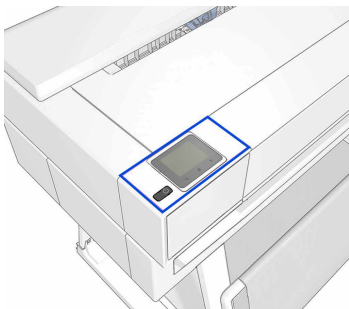

**Note:** Ensure that all covers are closed before powering-on the printer.

Once all the cables are connected, check that the printer is on. The control panel will now guide you through setup.



**IMPORTANT:** After finishing the printer setup, complete the driver configuration on a PC.



HP Click  
Driver



## Get the latest driver

Install the latest HP driver to print.  
For best performance, features, and reliability.

Install the latest HP driver to print.

1



Download at

[hp.com/go/T870/drivers](https://hp.com/go/T870/drivers)

# PC Configuration

# PC Configuration

## Windows: Install the driver from the support page

1

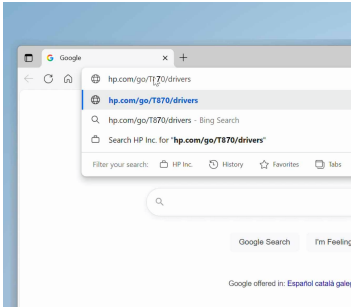

Open your web browser:

Go to: **hp.com/go/T870/driver**

2

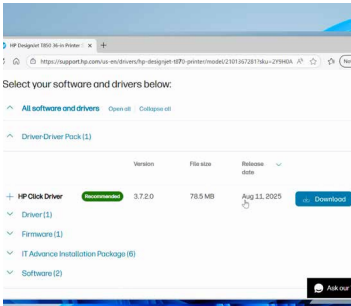

Download the Windows driver package.

3

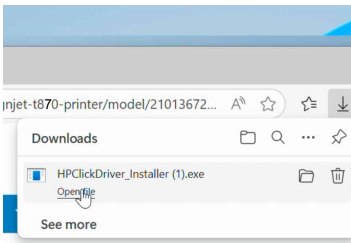

Double-click the .exe file and perform the installation wizard prompts to complete the driver installation.

4

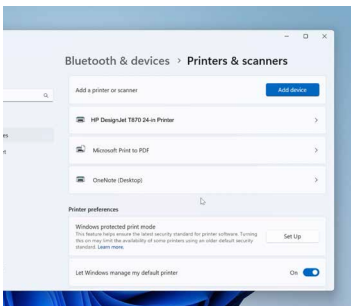

Confirm the correct installation.  
Go to **Settings > Bluetooth & Devices > Printer & Scanners**.  
Ensure your printer is listed.

# PC Configuration

## Windows: Install the driver from settings “Add printer”

1

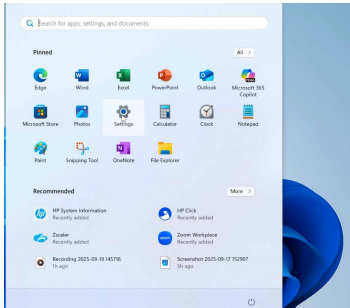

Open the windows menu and select settings.

2

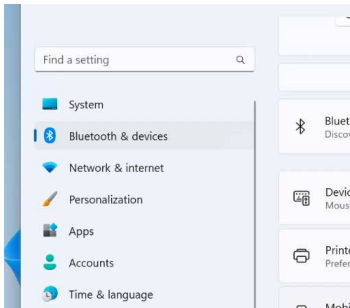

Select Bluetooth & Devices.

3

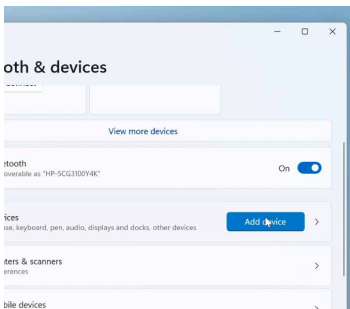

Click **Add device**. Windows will automatically install the drivers (or prompt you to download them).

4

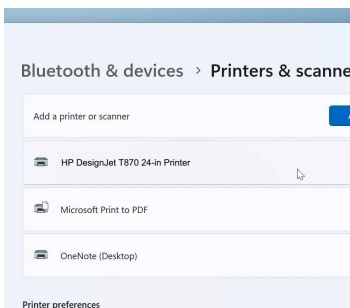

Once installed, the printer will appear in your list under Printers & scanners.



During the first print, you will be prompted to install the HP Click standalone application.

# MacOS: Install app

For the best printing experience, install HP Click

1

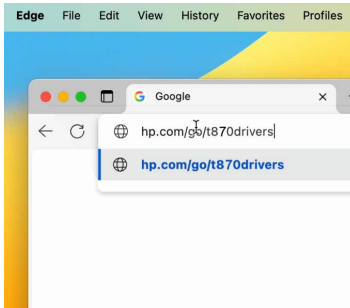

Open your web browser:

Go to: [hp.com/go/T870/driver](https://hp.com/go/T870/driver)

2

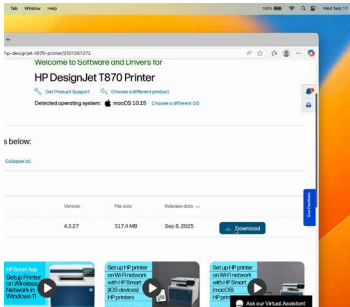

Download HP Click for MacOS.

3

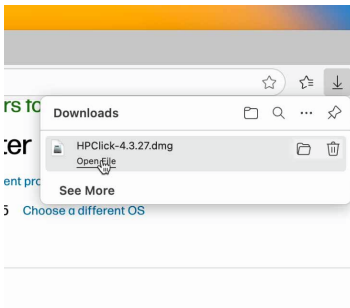

Install the app:

- Open the .dmg file.
- Drag the app into the applications folder.

4

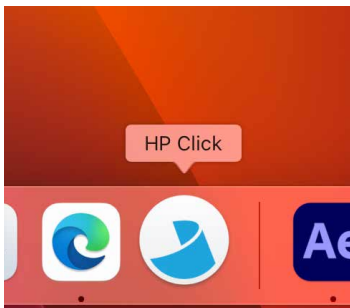

Launch the app by navigating to **HP Click**.

**Set your warranty coverage**



# Set your warranty coverage

1

<https://eoi.hpcloud.hp.com>

To finish the installation process, it is highly recommended to register the printer by accessing the following link and completing the End of Installation Registration Survey:

<https://eoi.hpcloud.hp.com/>

Registering the printer is important **to activate the free-coverage period**, which will be necessary for any future support request.

Edition 1

© Copyright 2025 HP Development Company, L.P.  
Large Format Division  
Camí de Can Graells 1-21  
08174 · Sant Cugat del Vallès  
Barcelona · Spain

The information contained herein is subject to change without notice. The only warranties for HP products and services are set forth in the express warranty statements accompanying such products and services. Nothing herein should be construed as constituting an additional warranty. HP shall not be liable for technical or editorial errors or omissions contained herein.